

## 1. Computer—A Smart Machine

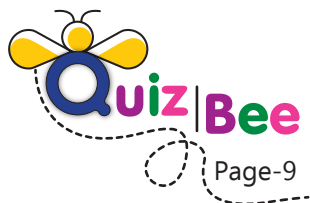

Answer: Laptop

### ASSESS YOURSELF

1. a. (iii)                      b. (iii)                      c. (ii)
2. a. T                          b. T                          c. T
3. a. (iii)                      b. (iv)                      c. (i)                      d. (ii)
4. a. PC                          b. Laptop                      c. Smartphone                      d. Supercomputers

5.

Can take decisions  
on its own

H

Needs instructions  
to work

C

Can make mistakes

H

Works on electricity

C

Works very fast

C

Does not get tired

C



{CODING ZONE}

=

Coding Zone

}

Coding Zone

Do it yourself

## 2. Uses of Computers

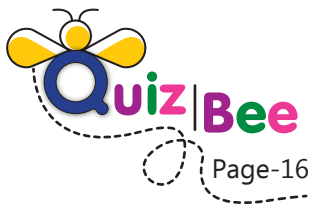

Answer: Keeping a record of bank accounts and customers. (any one)

### ASSESS YOURSELF

1. a. (iii)                      b. (iii)                      c. (iii)
2. a. robots                      b. cook                      c. e-mail
3. a. School                      b. Airport/Railway stations                      c. Hospital
4. a. Shop                      b. Hospital                      c. Bank
- 5.

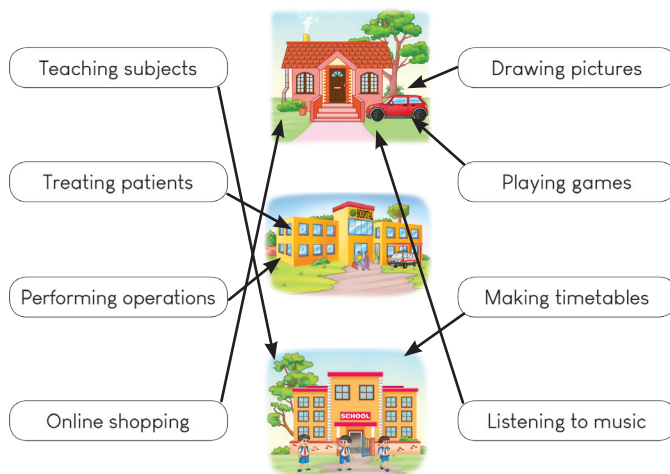

{CODING ZONE}

=

Coding Zone



Coding Zone

Do it yourself

## Periodic Assessment-1

(Based on chapters 1 & 2)

1. a. Desktop computer                      b. Tablet                      c. Supercomputer  
d. Laptop



Trackpad (Version 2.0)-II (Answer Key)

2. a. T                      b. F                      c. T                      d. F
3. a. LAPTOP              b. SCHOOL              c. SUPERCOMPUTER              d. AIRPORT

### 3. Operating a Computer

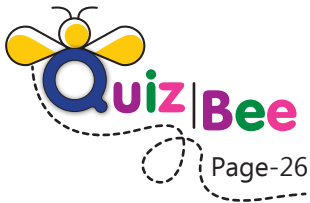

Answer: Title bar

#### ASSESS YOURSELF

1. a. (i)                      b. (ii)                      c. (iii)
2. a. F                      b. T                      c. T
3. Click and hold the left mouse button on the title bar.

Make sure the window is not maximized.

Click on the Restore Down button.

Drag the window to the location of your choice.

3

2

1

4

4.

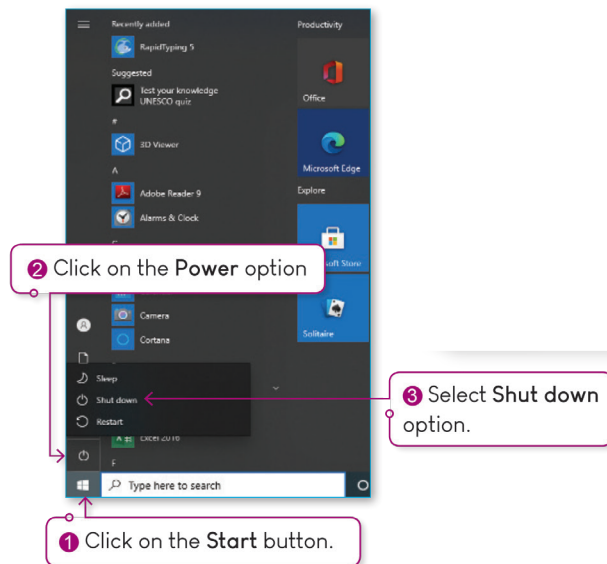

5. a. 3                      b. Shut down                      c. UPS



- a. I am not sad                      b. I am happy

## 4. How Computer Works?

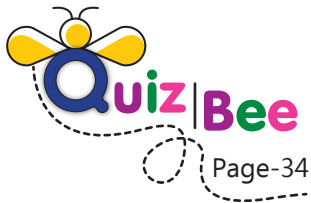

Answer: 1. Mouse                      2. Keyboard

### ASSESS YOURSELF

1. a. (iii)                      b. (ii)                      c. (iii)                      d. (ii)  
2. a. input                      b. output                      c. device                      d. CPU  
3. a. Input device                      b. Output device                      c. Output device                      d. Input device  
4. a.

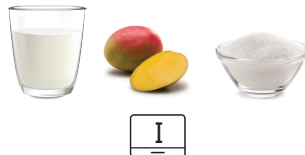

b.



5. a. Input-Process-Output                      b. Mouse, Keyboard  
c. Monitor, Printer. (any two)





Answer:	Input	Output
	10 less than 10	0
	5 less than 10	5
	8 more than 10	18

## Periodic Assessment-2

(Based on chapters 3 & 4)

1.

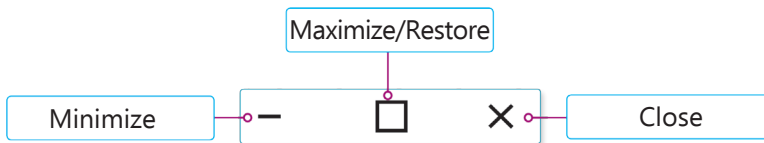

2.



P

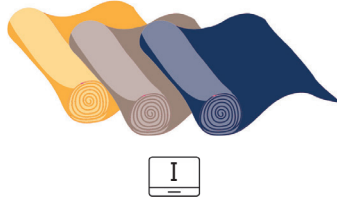

I



O

3. a. SPEAKERS      b. PRINTER      c. MOUSE

## Test Sheet-1

(Based on chapters 1 to 4)

- (ii)
  - (i)
  - (iii)
  - (i)
- F
  - T
  - F
- Monitor, Printer
  - Correct Instructions
  - Input is given to the computer which is then processed and an output is received. This process is called the IPO cycle.
  - Mouse, Keyboard
- Computers are used in schools for preparing test papers, worksheets, and results.
  - Computers are used in banks to maintain the records of the accounts of their customers.

## 5. Using a Mouse and a Keyboard

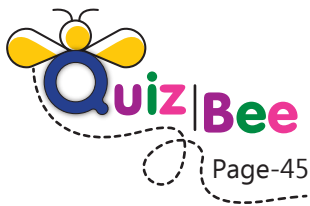

Answer: Keys

### ASSESS YOURSELF

- a. (iii)                      b. (i)                      c. (ii)                      d. (iii)
- a. mouse                      b. Enter                      c. two
- a. Gaming Mouse                      b. One                      c. Double-click
- a.                      b.                      c.                      d.

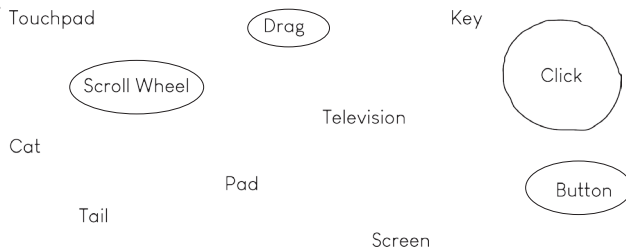

- a. @                      b. &                      c. F



{CODING ZONE}

=

Coding Zone

Coding Zone

- Answer: a. BEAR                      b. AIR                      c. BED                      d. RED

## 6. Typing in WordPad

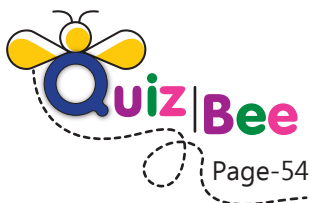

Answer: Clipboard, Font, Paragraph, Insert, Editing



Trackpad (Version 2.0)-II (Answer Key)

## ASSESS YOURSELF

- (iii)
  - (ii)
  - (i)
- T
  - F
  - F
- (iii)
  - (iv)
  - (i)
  - (ii)
- This command is used to make the text bold.
  - This command is used to change the colour of the text.
  - This command is used to underline the text.
- Ribbon and Title bar.
  - We can format and change the appearance of the text using wordpad.



{CODING ZONE}

=

Coding Zone

[]

Coding Zone

- 423
  - @#!&

## Periodic Assessment-3

(Based on chapters 5 & 6)

- (ii)
  - (iii)
  - (i)
  - (iv)
- Scrolling
  - Double-click
  - Right-click
- T
  - F
  - F
  - T

## 7. More on Paint & Paint 3D

## ASSESS YOURSELF

- (iii)
  - (ii)
  - (iii)
- F
  - F
  - T
  - F
- Magnifier tool helps us make a drawing look bigger.
  - Airbrush tool is used as a sprayer.
- Click-and-drag the mouse pointer to draw the text box.

Select the Text tool.

Change the size and colour of the text.

Type the text in the Text box.

2

1

4

3





Answer: a. 32 b. 7

## 8. More on Tux Paint

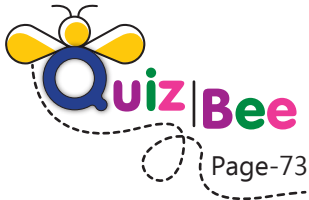

Page-73

Answer: 1. Toolbar 2. Drawing Canvas 3. Selector 4. Color Palette

Page 75

Answer: Fill tool

### ASSESS YOURSELF

- (iii)
  - (i)
  - (ii)
- F
  - T
  - T
  - F
- Follow these steps to add magic effects to the drawing;
    - Click on the Magic tool.
    - Select the desired effect, e.g. Rainbow effect.
    - Click and drag the pointer to draw a rainbow.
  - To draw with a freehand, click on the the Paint tool and drag on the canvas to draw the picture.
  - To close tux paint, click on the Quit tool.
- Magic tool is used to add special effects to the drawing.
  - Quit tool used to exit or close Tux Paint.
  - Text tool is used for adding text to the drawing.
- Open tool



Answer: a. MAGIC b. PAINT c. QUIT





# Periodic Assessment-4

(Based on chapters 7 & 8)

1. a. (iii)                      b. (v)                      c. (iv)                      d. (ii)                      e. (i)
2. **2D Shapes Tool**      **3D Shapes Tool**

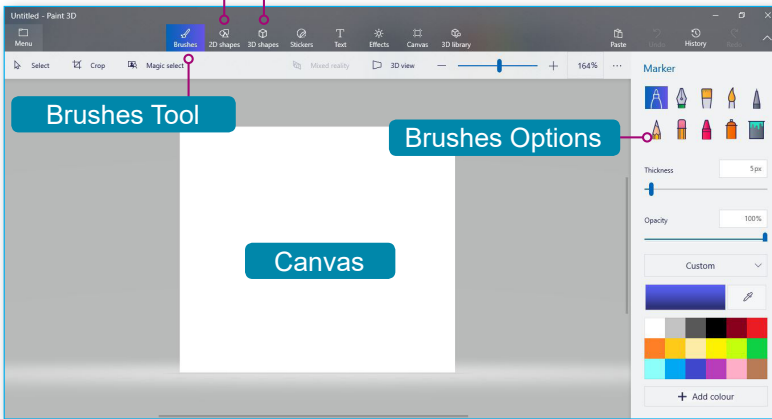

## Test Sheet-2

(Based on chapters 5 to 8)

1. a. (i)                      b. (ii)                      c. (ii)                      d. (iii)
2. a. enter                      b. wordpad                      c. magnifier
3. a. one

b. To close Tux Paint, follow these steps:

- ❶ Click on the Quit tool.
- ❷ Click on Yes, I'm done! option to quit the Tux Paint program.

If you haven't saved the drawing before quitting, you will be asked to save the drawing before quitting.

Click on No, don't bother saving! to quit the Tux Paint program without saving your picture.

- ❸ Click on the Yes, save it! option to save the drawing.

4. a. Ribbon and title bar. (any two)
- b. It is used to make a drawing look bigger.
- c. To draw a freehand drawing, we can use Paint tool to draw something in canvas.