

Name: _____

Roll No: _____

Class: _____ Section: _____ Date: _____

WINDOWS PHOTO EDITOR & VIDEO EDITOR

A. Tick (✓) the correct option.

- Which of the following used to view, edit, compare, create albums and make movies of your special memories?

a. Photos App	<input type="checkbox"/>	b. Word	<input type="checkbox"/>
c. Excel	<input type="checkbox"/>	d. PowerPoint	<input type="checkbox"/>
- Which of the following can change the intensity of the applied filter?

a. Rotate	<input type="checkbox"/>	b. Crop handles	<input type="checkbox"/>
c. Flip button	<input type="checkbox"/>	d. Filter intensity	<input type="checkbox"/>
- Which of the following increase/decrease brightness and contrast of a photo?

a. Filter intensity	<input type="checkbox"/>	b. Crop handles	<input type="checkbox"/>
c. Adjustments	<input type="checkbox"/>	d. Rotate	<input type="checkbox"/>

B. Write 'T' for true and 'F' for false.

- Filters rotate the photo in any direction.
- Cropping means changing the position of a photo at different angles.
- Flipping means getting the mirror image of the photo either horizontally or vertically.
- Storyboard is a horizontal bar containing various options to edit the video.
- Trimming a video means to cut the portion of a video.

C. Write the use of the following:



.....



.....



.....

Name: _____

Roll No: _____

Class: _____ Section: _____ Date: _____

ADVANCED FEATURES OF WORD 2019

A. Tick (✓) the correct option.

- Which of the following wavy line shows that a word has been spelt incorrectly?

a. Red	<input type="checkbox"/>	b. Blue	<input type="checkbox"/>
c. Green	<input type="checkbox"/>	d. Orange	<input type="checkbox"/>
- After selecting Spelling and Grammar tool, which task pane opens in the right side?

a. Spelling	<input type="checkbox"/>	b. Grammar	<input type="checkbox"/>
c. Proofing	<input type="checkbox"/>	d. Thesaurus	<input type="checkbox"/>
- Which of the following means the layout of the page?

a. Page break	<input type="checkbox"/>	b. Orientation	<input type="checkbox"/>
c. Line spacing	<input type="checkbox"/>	d. Paragraph spacing	<input type="checkbox"/>

B. Fill in the blanks using the hints given below:

Hints: Page break, Page formatting, Letter, Combines

- is the arrangement of text and all the elements of a page.
- is used to end a page at any point in the document.
- Merged document both the documents.
- The default paper size in Word is

C. Rearrange the letters and write the correct word.

- LLEPSNGI
- RAMMARG
- EHTUASRUS
- ECALPER

Name: _____

Roll No: _____

Class: _____ Section: _____ Date: _____

Chapter-3

CLASS 5

MORE ON POWERPOINT 2019

A. Tick (✓) the correct option.

- Animated objects make a presentation more
 a. Attractive ☐ b. Dull ☐ c. Boring ☐
- Which of the following tab appears when an audio or video element is added to a slide?
 a. Format ☐ b. Playback ☐ c. Both a. and b. ☐
- Which of the following is not a printing option?
 a. Print All Presentations ☐ b. Print Selection ☐
 c. Custom Range ☐ d. Print Current Slide ☐

B. Write 'T' for true and 'F' for false.

- Action buttons can be used to link any other application to the current slide.
- Video clips can be added to a slide by selecting the Home tab.
- You cannot add more than one animation to the same object.
- Transition effects give motion to the text and pictures.
- You cannot apply the same transition effect to different slides

C. Label the given image:

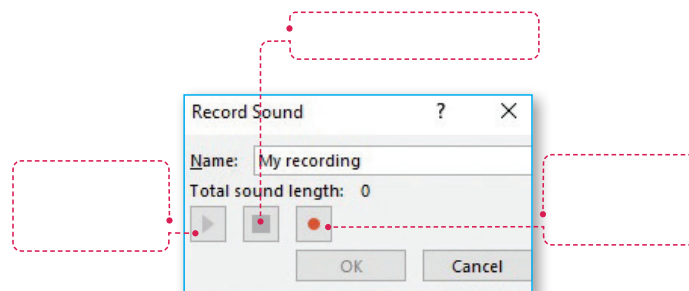

Name: _____

Roll No: _____

Class: _____ Section: _____ Date: _____

INTRODUCTION TO EXCEL 2019

A. Tick (✓) the correct option.

1. Which of the following option displays the contents of the active cell?

a. Cell

☐

b. Active cell

☐

c. Formula Bar

☐

d. Sheet tab

☐

2. Which of the following are the vertical sections of the table?

a. Worksheet

☐

b. Ribbon

☐

c. Rows

☐

d. Columns

☐

3. Which key moves the active cell one row up?

a. →

☐

b. ↓

☐

c. ↑

☐

d. ←

☐

B. Fill in the blanks using the hints given below:

Hints: Down, Enter, Rows, Tab

1. The button is used to insert the text.

2. Enter key moves the active cell one row.

3. key moves the active cell one column to the right.

4. The total number of is 1,048,576.

C. Label to add/rename/remove a worksheet.

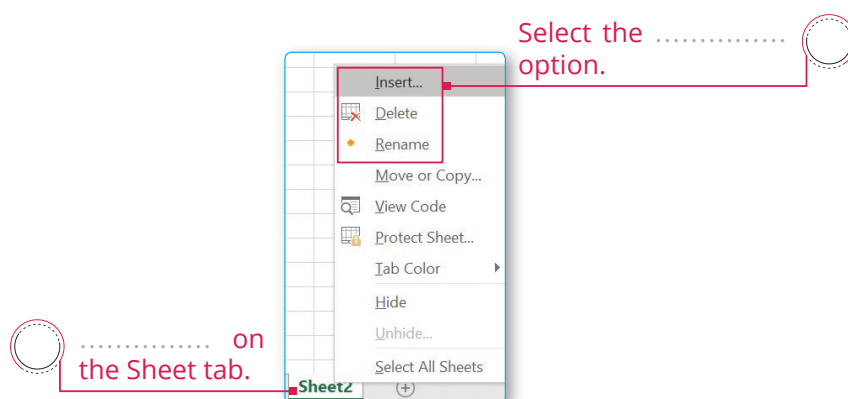

Name: _____

Roll No: _____

Class: _____ Section: _____ Date: _____

EDITING CELL CONTENTS IN EXCEL 2019

A. Tick (✓) the correct option.

- Which of the following option is a rectangular section of cells which are next to each other and at least one side of their border is common?

a. Range	<input type="checkbox"/>	b. Column	<input type="checkbox"/>
c. Cell	<input type="checkbox"/>	d. None of these	<input type="checkbox"/>
- Which of these can't you fill using AutoFill feature in Excel?





a. Numbers	<input type="checkbox"/>	b. Days	<input type="checkbox"/>
c. Heights of your classmates	<input type="checkbox"/>	d. Hours	<input type="checkbox"/>
- Which of the following feature in Excel is used to automatically fill a series of data in rows and columns?

a. Undo	<input type="checkbox"/>	b. Redo	<input type="checkbox"/>
c. Autofill	<input type="checkbox"/>	d. Range	<input type="checkbox"/>

B. Answer the following in one or two words:

- What is the shortcut to select the whole worksheet?
- Which key is used to select a range of cells?
- Which key is used to select the multiple cells?
- What is the shortcut to apply the default time format?

C. Match the following:

- | | |
|--|-----------------|
| 1.  | a. Paste option |
| 2.  | b. Copy |
| 3.  | c. Cut |
| 4.  | d. Fill button |

Name: _____

Roll No: _____

Class: _____ Section: _____ Date: _____

Chapter-6

CLASS 5

INTERNET AND E-MAIL

A. Guess! Who am I?

- I use radio frequency to connect to the Internet.
- I allow users to connect to the Internet using their smartphones.
- I am an application software that is used to find information from the different websites.
- I am a global network of millions of computers.
- I require users to link their phone line to a computer in order to access the Internet.
- I provide Internet access only through cable.

B. Complete the steps to send an E-mail.

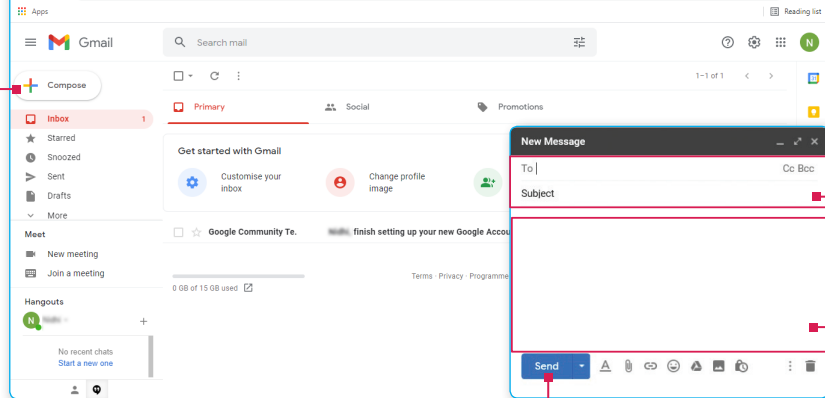

1 Click on the button.

..... the details.

..... the e-mail.

Click on button.

C. Competency-based/Application-based question:

Sahil needs to send an e-mail to some people. But he wants only Vijay to respond to it. Where should he write Vijay's e-mail address and others e-mail addresses?

.....

.....

Name: _____

Roll No: _____

Class: _____ Section: _____ Date: _____

SAFEGUARDING YOUR COMPUTER

A. Write about the following malwares:

1. ILOVEYOU Virus

.....

2. Zeus

.....

3. Pegasus

.....

4. Wabbit Virus

.....

B. Match the following:

1.



a. Norton

2.



b. McAfee

3.



c. AVG

C. Answer the following:

1. Write any two symptoms of an infected computer.

.....

.....

2. Write a short note on Antivirus. Name few of them.

.....

.....



Name: _____

Roll No: _____

Class: _____ Section: _____ Date: _____

DATA PROCESSING

A. Tick (✓) the correct option.

1. In a code language QUEEN is written as OVCFL then how KING can be written?

a. IJLH

☐

b. MKOF

☐

c. PHIK

☐

d. FOKM

☐

2. What is arranging data in a specific order called?

a. Processing

☐

b. Sorting

☐

c. Decoding

☐

d. Filtering

☐

3. In a code language GOLD is written as 7\$8#0 then how GOOD can be written?

a. 78#0

☐

b. 7\$50

☐

c. 700\$

☐

d. 7##0

☐

B. Answer the following questions:

1. What is the difference between Maps and Pictograms?

.....

2. Write one difference between Data and Information.

.....

C. Sort the items given below:



	Name of the Item	Number of the Item
1.	Racket	
2.	Gloves	
3.	Tennis ball	
4.	Shoes	



WORKSHEET

Name: _____

Roll No: _____

Class: _____ Section: _____ Date: _____



MORE ON SCRATCH

Chapter-9

CLASS 5

Grade:



Teacher's Signature: _____

Name: _____

Roll No: _____

Class: _____ Section: _____ Date: _____

ROBOTICS



A. Write about the following latest robots:

1. Nao
2. T-HR3
3. Zenbo
4. Dash & Dot

B. Match the following:

- | | |
|---------------|--|
| 1. Flyability | a. a human like robote |
| 2. Z-Machines | b. world's first collision-tolerant flying robot |
| 3. Paro | c. are music-band |
| 4. Nadine | d. a talking robot used for therapy |

C. Identify fields where the following robots are used:

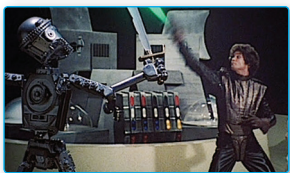
1. 
2. 
3. 
3. 