

Name: \_\_\_\_\_

Roll No: \_\_\_\_\_

Class: \_\_\_\_\_ Section: \_\_\_\_\_ Date: \_\_\_\_\_

## A COMPUTER SYSTEM

Chapter-1

CLASS 3

### A. Tick (✓) the correct option.

1. Which part of the CPU is responsible for performing calculations?

a. CU

☐

b. ALU

☐

c. MU

☐

d. None of these

☐

2. The data or instructions we give to the computer is called .....

a. input

☐

b. output

☐

c. storage

☐

d. processing

☐

3. Computer works on the ..... cycle.

a. IPO

☐

b. FIFO

☐

c. IOP

☐

d. None of these

☐

### B. Fill in the blanks using the words given below:

**Hints:** CPU, Information, CU, Hardware

1. Physical components of a computer system are called .....

2. The ..... coordinates between all the parts of the CPU.

3. The memory of the ..... stores data and instructions.

4. The meaningful and organized form of data is called .....

### C. Write 'T' for true and 'F' for false.

1. CPU is made up of ALU, CU, and MU. ....

2. Speakers are the storage device. ....

3. Joystick is an output device. ....

Grade:



Teacher's Signature: \_\_\_\_\_

Name: \_\_\_\_\_

Roll No: \_\_\_\_\_

Class: \_\_\_\_\_ Section: \_\_\_\_\_ Date: \_\_\_\_\_

## COMPUTER MEMORY

### Chapter-2

### CLASS 3

#### A. Tick (✓) the correct option.

1. Which one of these is not a secondary storage device?

a. RAM

☐

b. DVD

☐

c. Pen Drive

☐

d. None of these

☐

2. Which one of these is used to record and erase data any number of times?

a. CD-ROM

☐

b. DVD-R

☐

c. CD-RW

☐

d. None of these

☐

3. Which one of these is used to measure the memory of a computer?

a. litre

☐

b. byte

☐

c. inches

☐

d. None of these

☐

#### B. Fill in the blanks using the hints given below.

**Hints:** Read Only Memory, 1 GB, Random Access Memory, USB

1. .... is full form of RAM.

2. .... is full form of ROM.

3. .... equals 1024 MB.

4. External hard disks can be connected with the help of ..... ports.

#### C. Rearrange the letters to make the correct words.

1. C M O A P T C







2. M A R S





3. V O T L A I L E







4. N B B I E L

Name: \_\_\_\_\_

Roll No: \_\_\_\_\_

Class: \_\_\_\_\_ Section: \_\_\_\_\_ Date: \_\_\_\_\_

## LET'S KNOW ABOUT WINDOWS 10

Chapter-3

CLASS 3

### A. Tick (✓) the correct option.

- The bar at the bottom of the desktop is called .....  
 a. Icons ☐ b. Gadgets ☐  
 c. Taskbar ☐ d. Wallpaper ☐
- Which of these is the first screen that appears after switching on the computer?  
 a. Icon ☐ b. Desktop ☐  
 c. Taskbar ☐ d. Gadgets ☐

### B. Write 'T' for true and 'F' for false.

- The clock is present in the left side on the taskbar. ....
- Pressing the right button of the mouse displays the shortcut menu or pop-up menu. ....
- Double-clicking on the icon opens the window. ....
- Start button is present on the taskbar. ....

### C. Answer the following questions:

- What are icons?  
.....
- What is Windows 10?  
.....

### D. Fill in the missing letters.

- D       S       T       P
- B       C       G       O       N
- F       L       E
- D       V       C          S

Name: \_\_\_\_\_

Roll No: \_\_\_\_\_

Class: \_\_\_\_\_ Section: \_\_\_\_\_ Date: \_\_\_\_\_

## ADVANCED FEATURES OF PAINT

Chapter-4

CLASS 3

### A. Tick (✓) the correct option.

1. Which of the following tools is used to draw a triangle shape?

a. Rectangle

☐

b. Right Triangle

☐

c. Oval

☐

d. None of these

☐

2. Which of the following tools is used to draw a straight line?

a. Line

☐

b. Oval

☐

c. Rectangle

☐

d. Eraser

☐

### B. Label the steps in the following window to draw a callout:

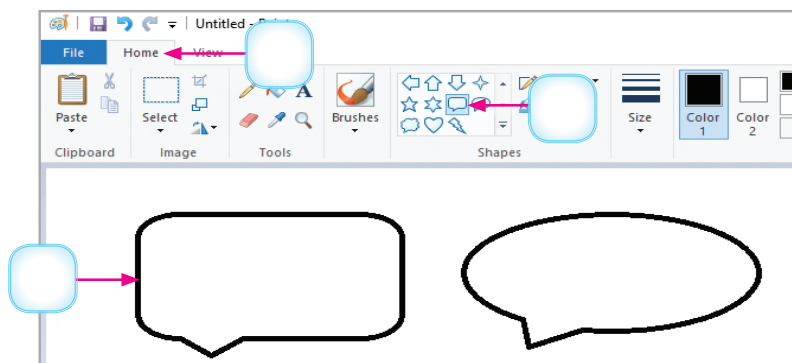

### C. Match the following:

1. Square

a. 5 Sides

2. Triangle

b. 4 sides

3. Penatgon

c. 3 sides

Name: \_\_\_\_\_

Roll No: \_\_\_\_\_

Class: \_\_\_\_\_ Section: \_\_\_\_\_ Date: \_\_\_\_\_

## MORE ON PAINT

### Chapter-5

### CLASS 3

#### A. Tick (✓) the correct option.

1. Which command gives a closer and bigger look of an image?

a. Crop

☐

b. Skew

☐

c. Zoom

☐

d. Rotate

☐

2. Which of these commands is used to change the size of an image in Paint?

a. Resize

☐

b. Zoom

☐

c. Crop

☐

d. None of these

☐

3. The Flip/Rotate command is present in the ..... group.

a. Colors

☐

b. Image

☐

c. Shapes

☐

d. Tools

☐

#### B. Write 'T' for true and 'F' for false.

1. Curve shape is used to draw squares with rounded corners. ....

2. Paint is a program used to draw and colour images. ....

3. Fill with Color tool is used to fill colour in closed figures. ....

#### C. Answer the following questions:

1. What are the two ways to flip an image?

.....

2. Where is the Zoom command present in MS Paint window?

.....

3. What does the Text tool help you do?

.....

Name: \_\_\_\_\_

Roll No: \_\_\_\_\_

Class: \_\_\_\_\_ Section: \_\_\_\_\_ Date: \_\_\_\_\_

## INTRODUCTION TO GOOGLE BLOCKLY

Chapter-8

CLASS 3

### A. Tick (✓) the correct option.

1. .... is also known as a play-way programming platform.

a. Paint

☐

b. Google Blockly

☐

c. Paint 3D

☐

d. None of these

☐

2. A snail has ..... Legs.

a. 0

☐

b. 2

☐

c. 4

☐

d. 6

☐

3. Which of the following is the trait of snail?

a. Beak

☐

b. Feather

☐

c. Slime

☐

d. Fur

☐

### B. Write 'T' for true and 'F' for false.

1. Google Blockly is a tool that helps the users to learn block-based programming quickly and easily. ....

2. The Blockly Games webpage has eight different games. ....

3. In the Maze game, the user has to match the picture of the animal/bird with its name. ....

4. Beak is a trait of Cat. ....

### C. Complete the following steps to start Blockly.

Step 1 Open the .....

Step 2 Type www.blockly.games in the ..... of the web browser.

Step 3 Press ..... key.

Grade:



Teacher's Signature: \_\_\_\_\_